

#26405 Filed This 2 day of June 1970
 And Recorded in Vol. 4E Page 21 at 11:53 A.M.

Ollie Farnsworth
 Register Mesne Conveyance Greenville County, S. C.

4E-21

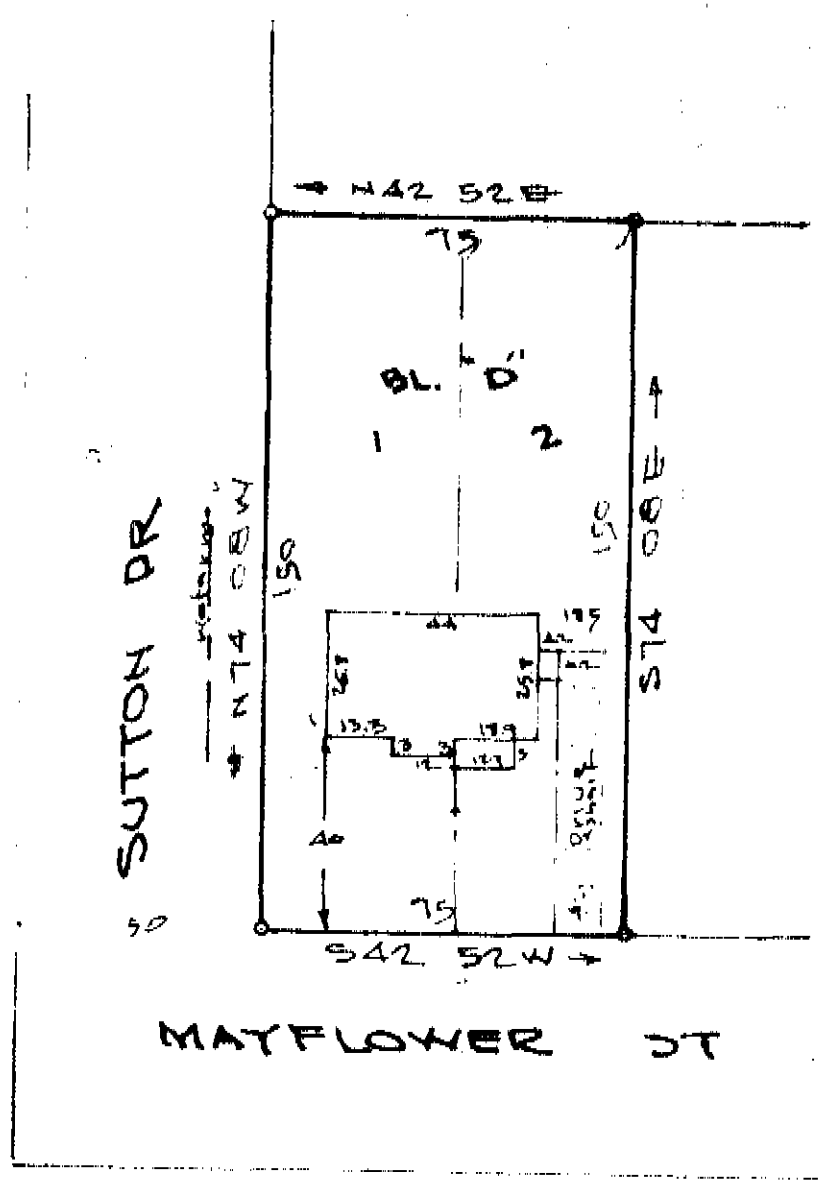

JUN 2 11 53 AM '70
 OLLIE FARNSWORTH
 R.M.C.

26405 ✓
 50' 4E-21

This is to certify that on the 17th day of MAY 1970, I surveyed the property shown on this plat, being LOTS 1 & 2 - BUENA VISTA, recorded in Plat Book W of the R.M.C. Office for Greenville County, S. C., and that the property lines, walls and buildings are as shown hereon; that the buildings located on said lot do not encroach or project on adjacent streets or property; and that no adjacent buildings or walls encroach or project on said premises, and that no utility lines cross this property.

PROPERTY OF
 CHARLES E. KELLET
 ANNA MARY C KELLEY
 GREENVILLE COUNTY, SC

Scale 1"=40' MAY 17, 1970

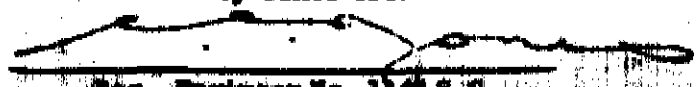

Reg. Engineer No. 1164 S.C.